

Hydraulic Clamp Nut

Fixed connection - type round

NORIS

Series N40

Features of series

**Axial connection
with pumpstand**

**Medium remains into
the pumpstand**



The pressure is based by the fixed connection of an external pumpstand.
The internal medium will flow into the circular groove and raise the ring piston.
Pressure rate is shown precisely at the pump stand pressure gauge.
Relieving the system is based on the pumpstand function.
After relieve you have to turn the nut to the opposite direction .
The Medium flows back to the pumpstand.

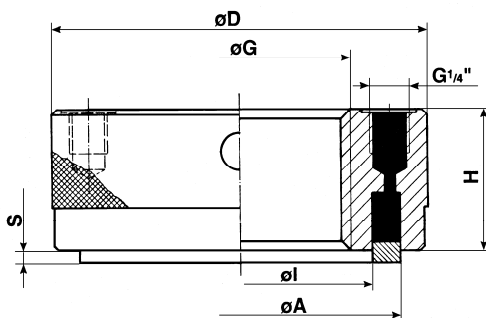

Clamping range
4 mm
6 mm
10 mm

Thread $\varnothing G_{max.}$	Ring piston		Outer Diameter $\varnothing D$	Height H	Clamping Force in kN Pump with max.working pressure		Part No Clamping range S
	$\varnothing A$	$\varnothing I$			400 bar	700 bar	
4 mm							
36	66	46	80	50	70	120	040.04.036
52	82	62	96	50	90	160	040.04.052
6 mm							
80	115	95	135	55	130	230	040.06.080
100	130	112	150	55	135	240	040.06.100
140	175	115	195	55	205	360	040.06.140
10 mm							
36	66	46	85	60	70	120	140.10.036
52	82	62	100	60	90	160	140.10.052

Against corrosion our hydraulic clamp nuts are protected with a brown finish.
The standard sealing systems are suitable for temperatures up to 80°.
The ring piston is locked against drop out.

Special design of hydraulic clamp nuts on request

NORIS

ARMATUREN BURKENSTEIN GMBH & CO. KG
- ABTEILUNG SPANNELEMENTE -

D-90411 Nürnberg
Puscherstraße 3

Telefon: + 49 (0) 911/ 52 15 06 3
Telefax: + 49 (0) 911/ 52 24 40

E-Mail: noris@noris-armaturen.de
Internet: www.noris-armaturen.de